

Toyota Auris 5P Hybrid (2013 -)
Toyota Auris Touring Sports Hybrid (2013 -)

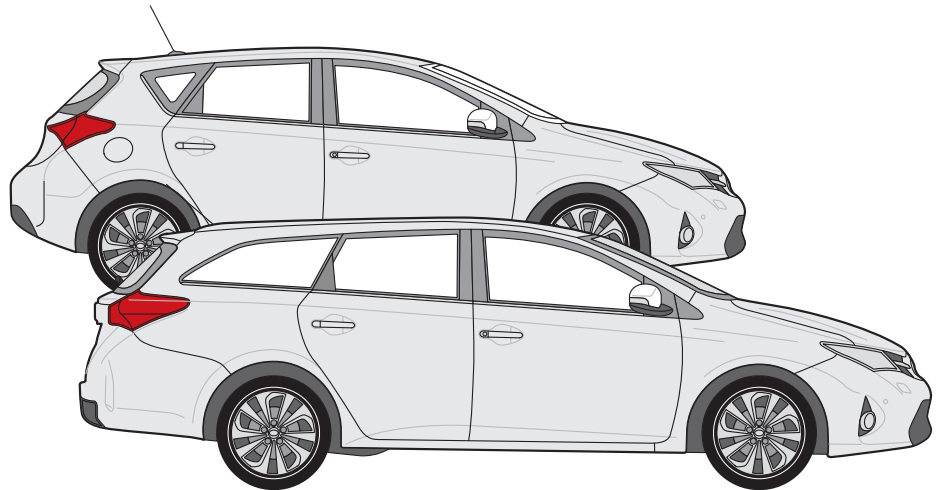

R55

Toyota Auris Hybrid (2013 -)
Toyota Auris Touring Sports Hybrid (2013 -)

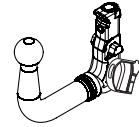
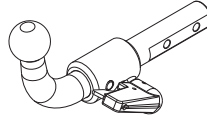
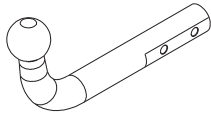

TowCar enganches **aragon**

E13 APPROVALNUMBER: 55R-01 3844 D-VALUE: 4,48 kN

TYPE: TOY043 CLASS: A50-X MAX.VERT.LOAD: 54 kg

TowCar enganches **aragon**

E13 APPROVALNUMBER: 55R-01 3845 D-VALUE: 4,48 kN

TYPE: TOY044-S CLASS: A50-X MAX.VERT.LOAD: 54 kg

TowCar enganches **aragon**

E13 APPROVALNUMBER: 55R-01 3845 D-VALUE: 4,48 kN

TYPE: TOY044-V CLASS: A50-X MAX.VERT.LOAD: 54 kg

D = 4,48 kN



S = 54 kg

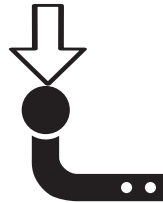

*T = 600 Kg



N/m	8,8	10,9	12,9
M6	10	15	18
M8	24	36	42
M10	51	75	87
M12	87	130	147
M14	138	198	231
M16	200	289	341

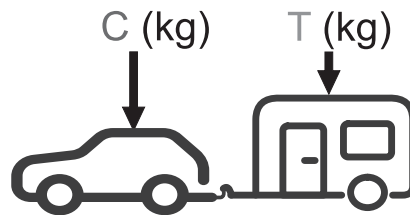

$g = 9,81 \text{ m/s}^2$







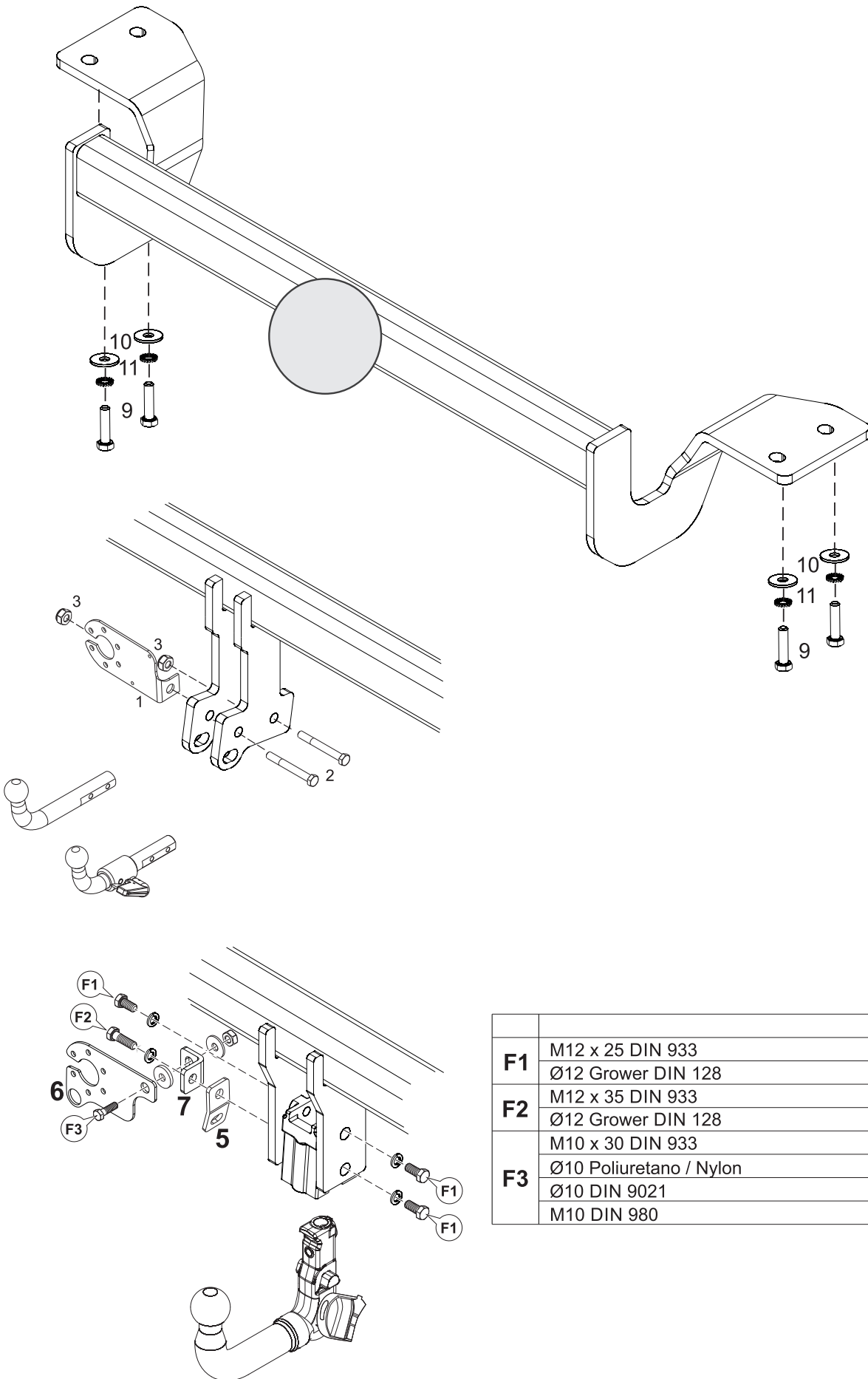

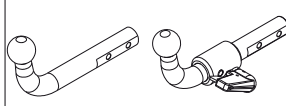
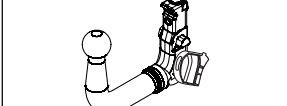

$$D \geq \frac{T \cdot C}{T + C} \cdot \frac{g}{1000} \text{ (kN)}$$

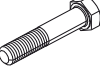
$$T \leq \frac{C \cdot D \cdot 1000}{(C \cdot g) - (1000 \cdot D)} \text{ (kg)}$$

*El MMR (T) puede variar dependiendo del vehículo.

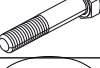

		#
F1	M12 x 25 DIN 933	3
	Ø12 Grower DIN 128	3
F2	M12 x 35 DIN 933	3
	Ø12 Grower DIN 128	1
F3	M10 x 30 DIN 933	1
	Ø10 Poliuretano / Nylon	1
	Ø10 DIN 9021	1
	M10 DIN 980	1

				
1		AEV0005	1	
2		M10x65 DIN 931	2	
3		M10 DIN 980	2	
4		AEV0004	1	1
5		AEV0006		1
6		AEV0009		1
7		AEV0008		1
8		C6417B	1	1
9		M12x1,25x40 DIN 961	4	4
10		Ø12 DIN 9021	4	4
11		Ø12 DIN 128A	4	4

1

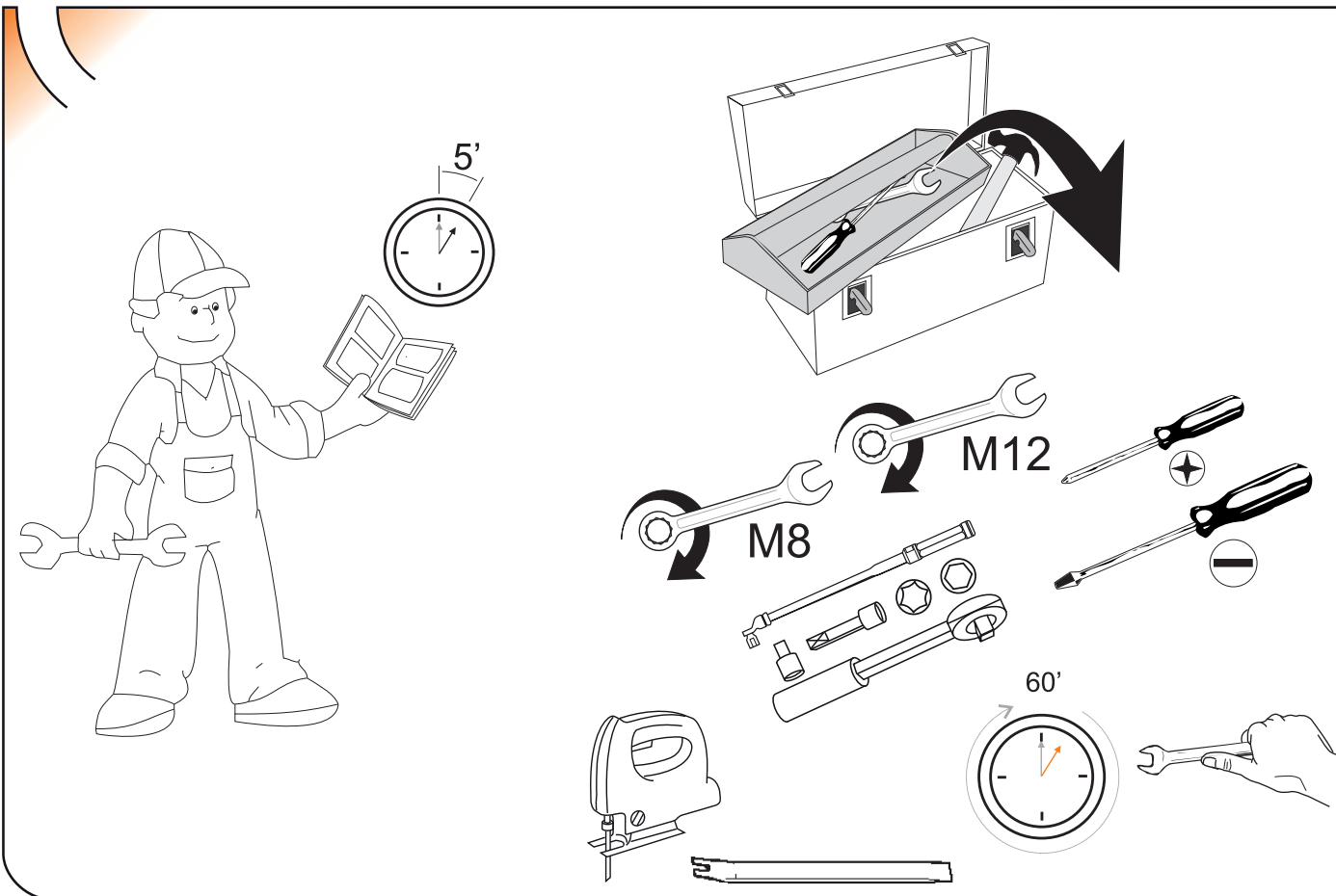

2

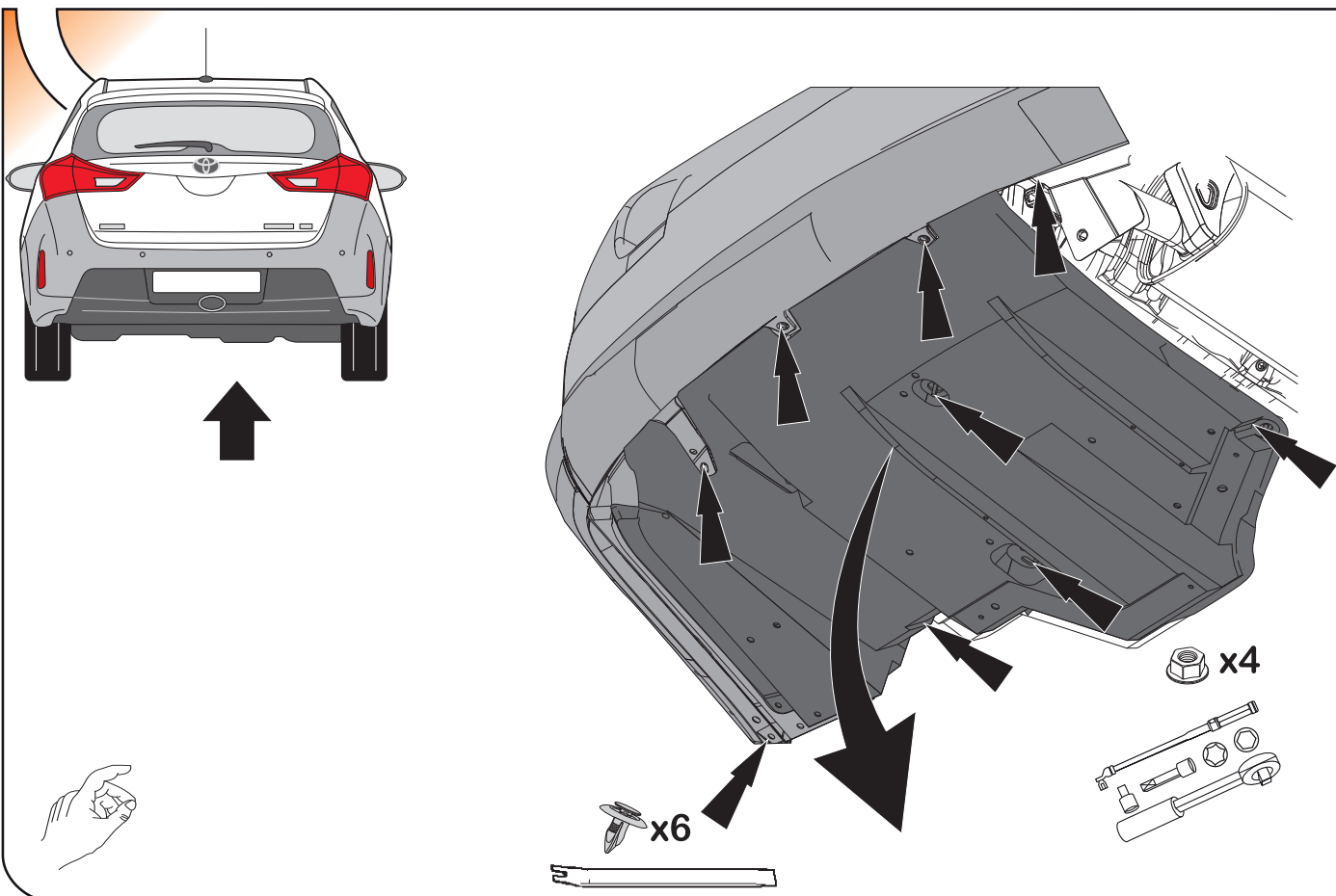

3

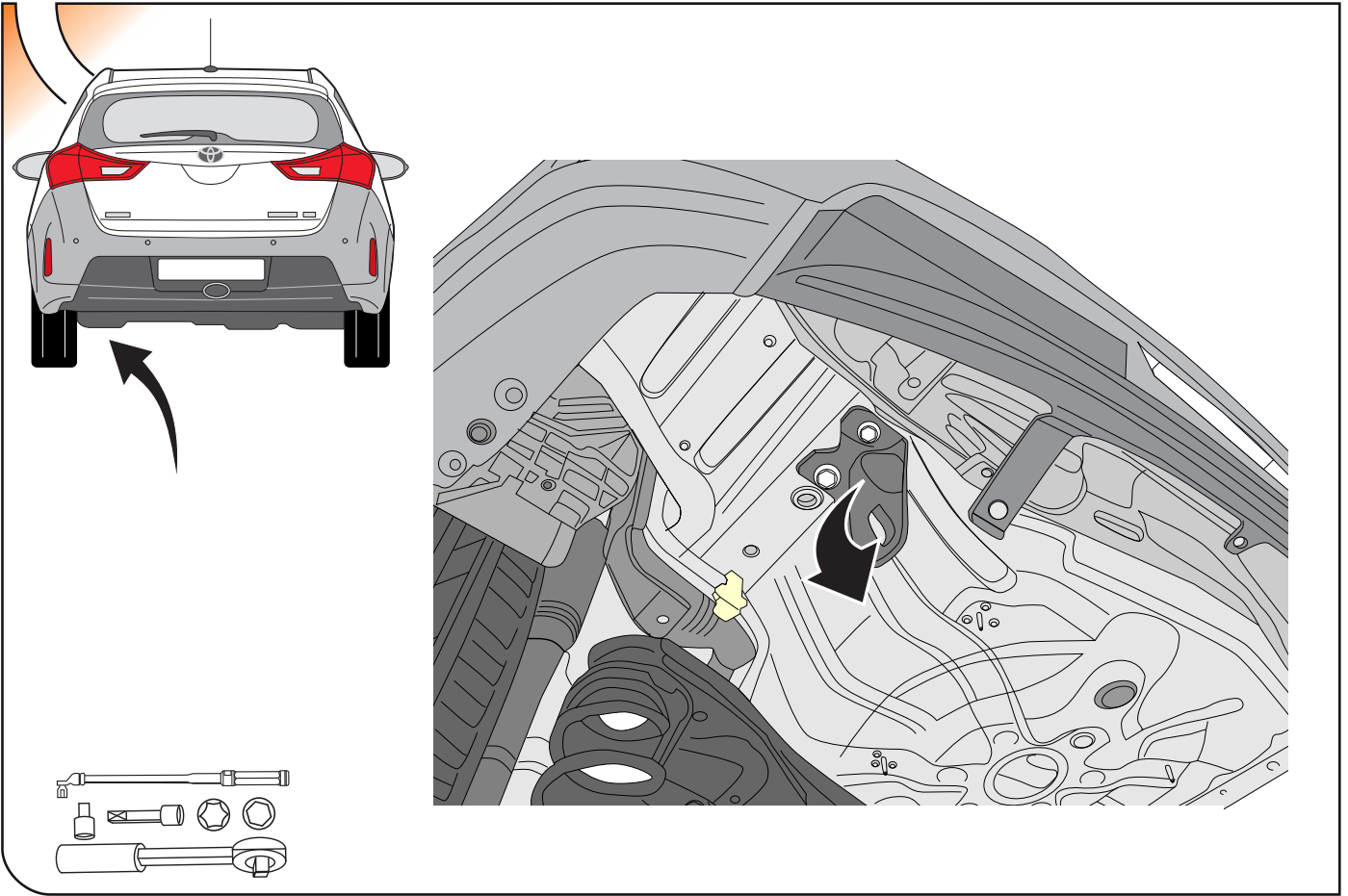

4

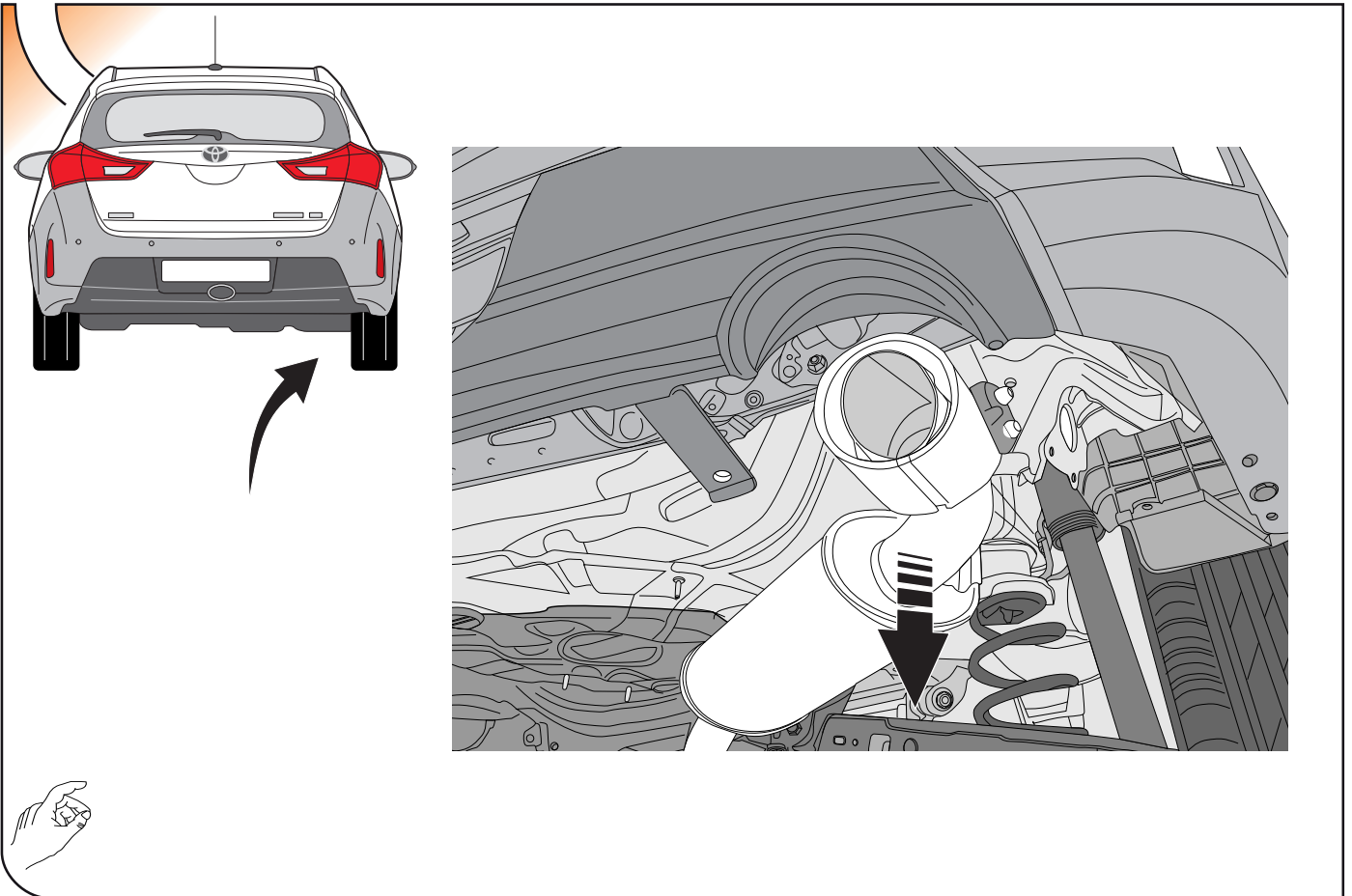

5

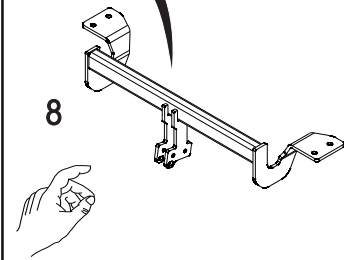
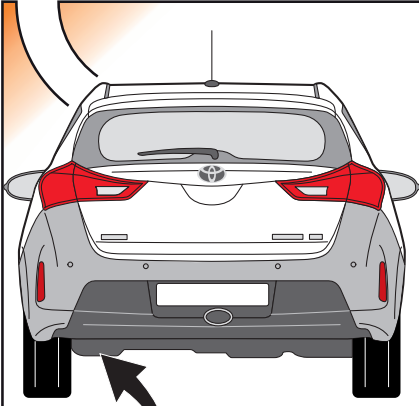

9.  x2 M12 x 1,25 x 40

10.  x2 Ø 12

11.  x2 Ø 12

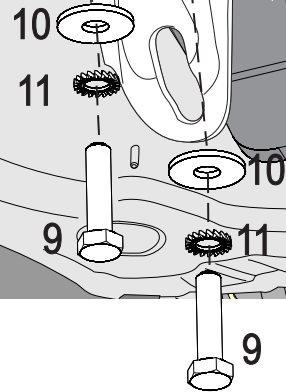
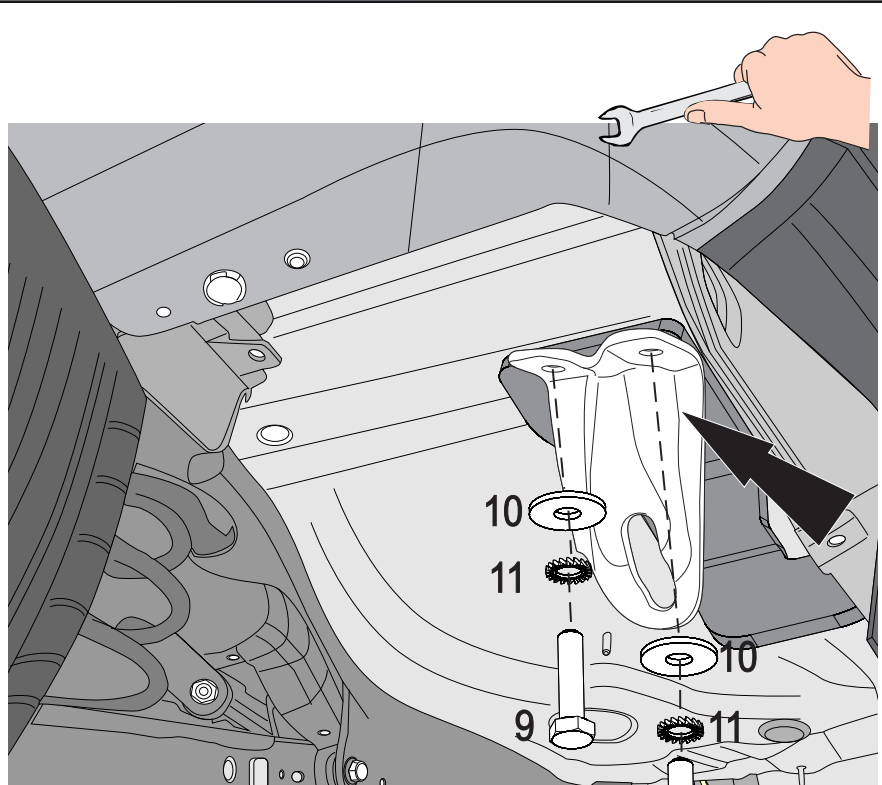

6

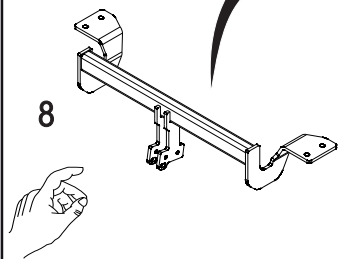
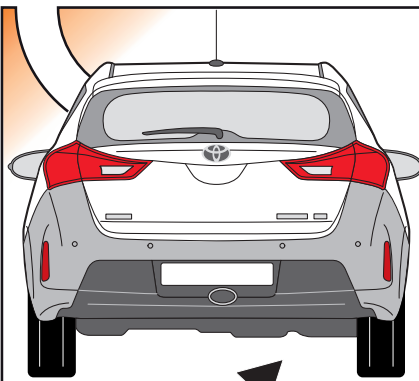

9.  x2 M12 x 1,25 x 40

10.  x2 Ø 12

11.  x2 Ø 12

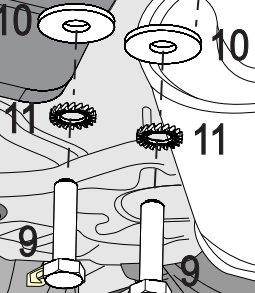
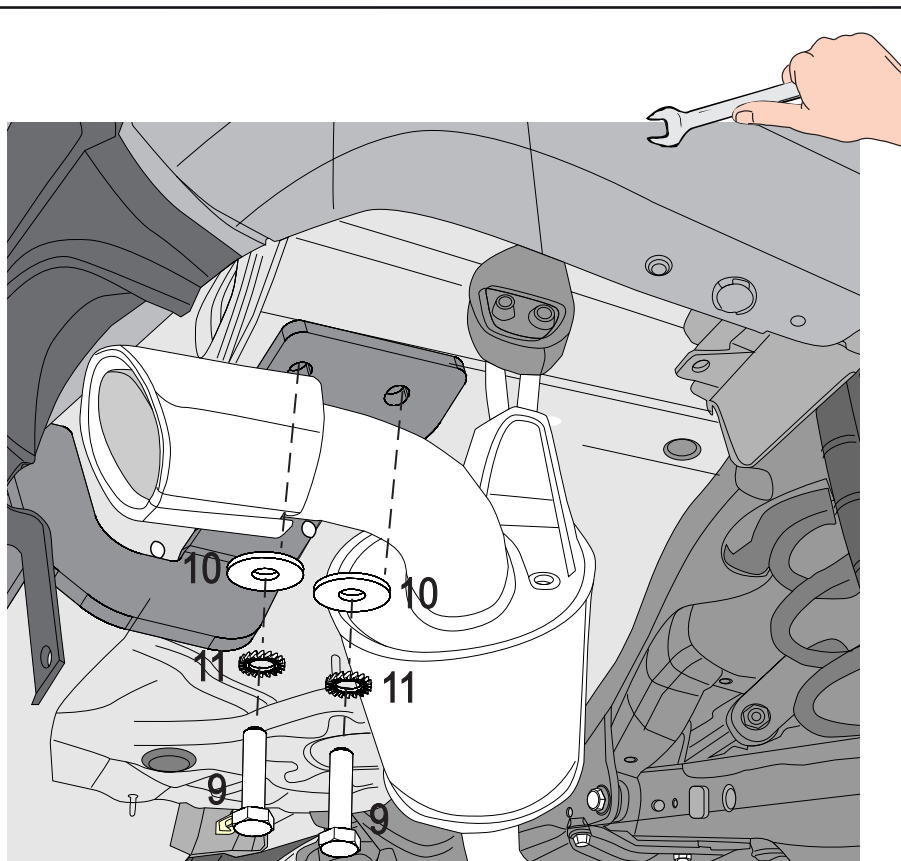

7

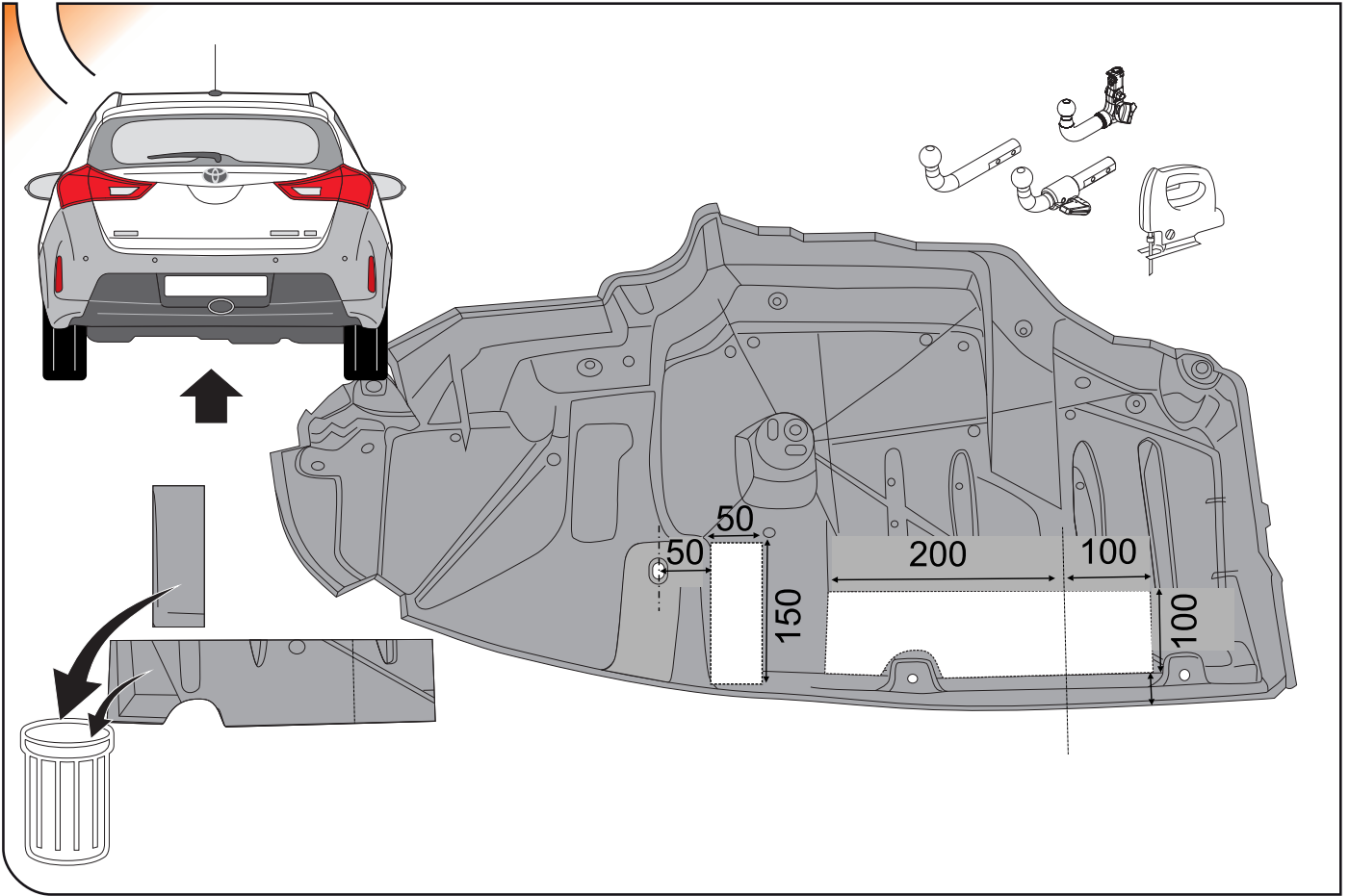

8

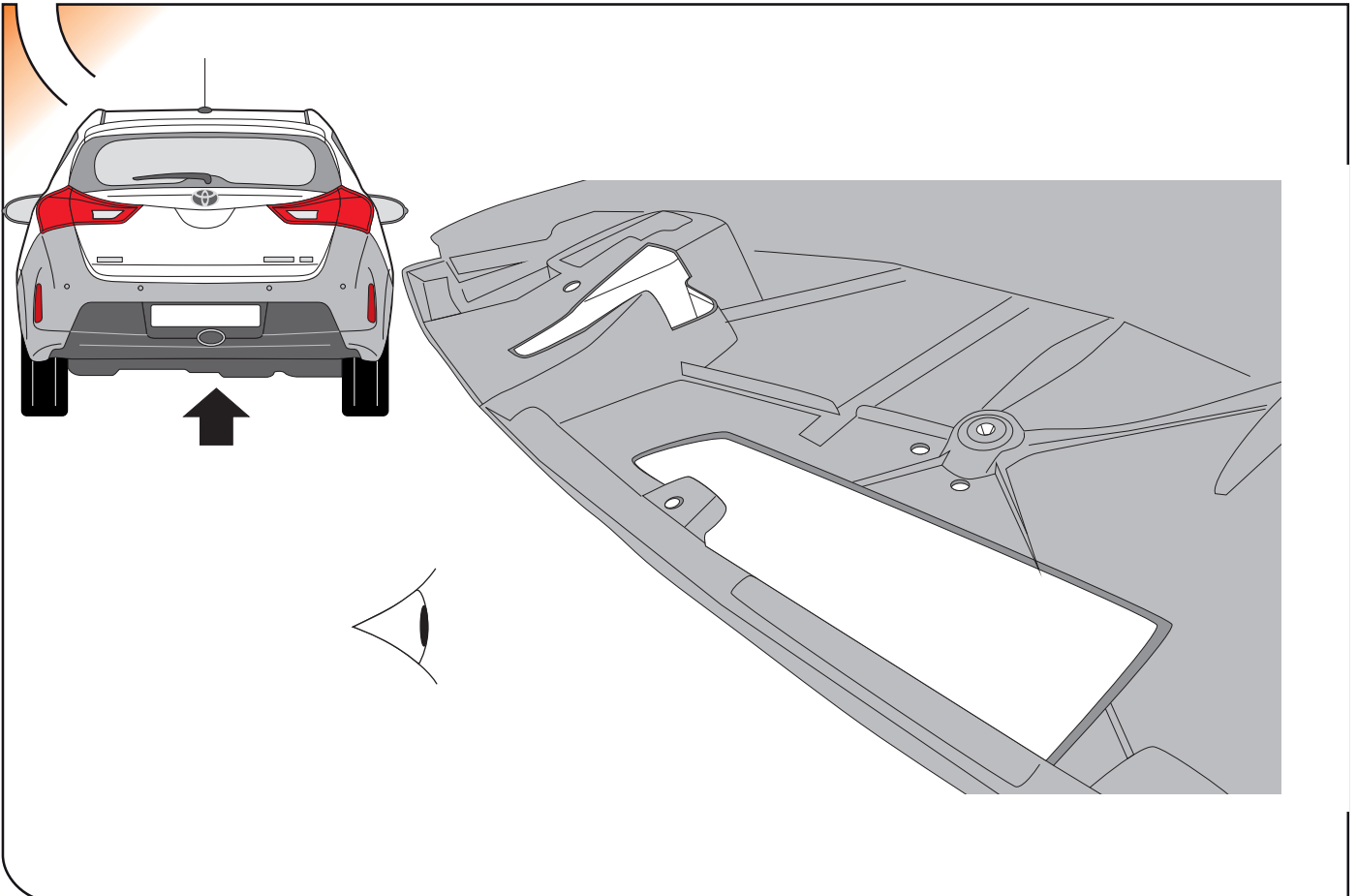

9

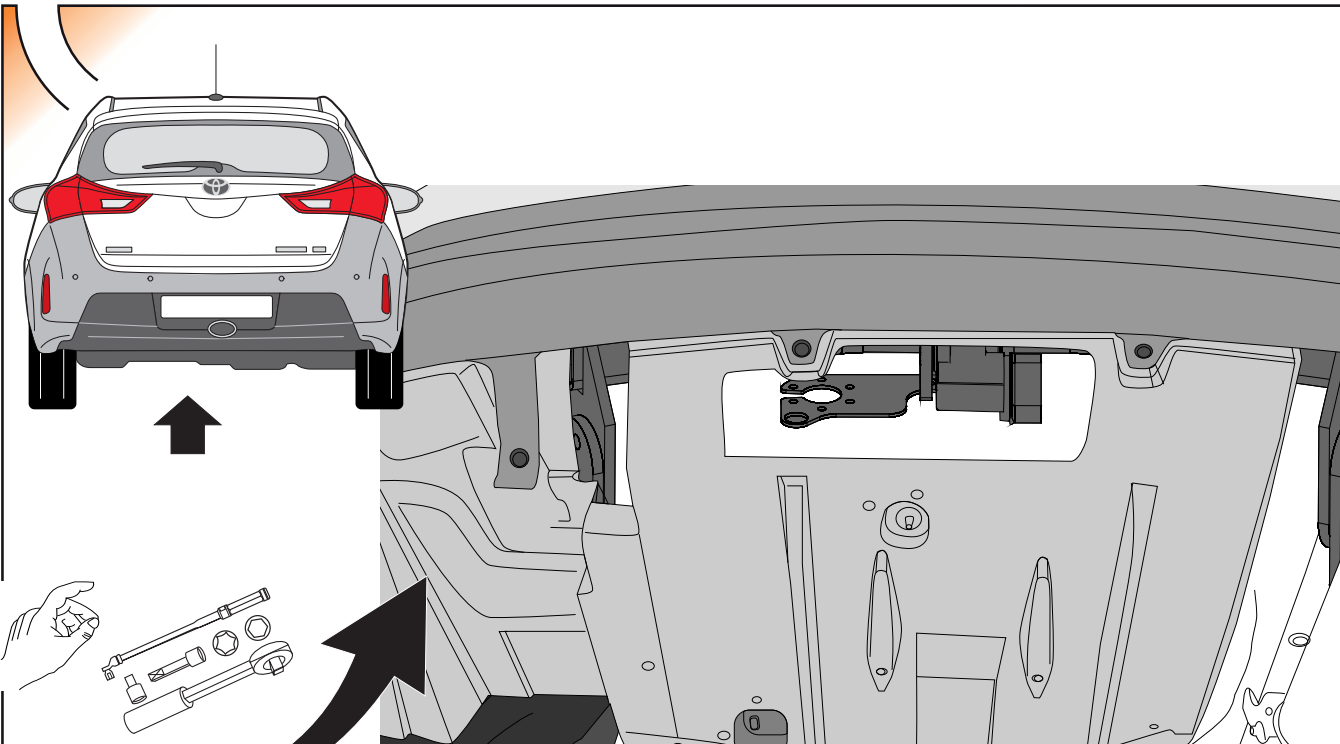

x4 

x6 

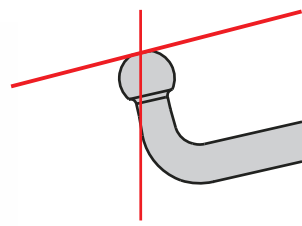
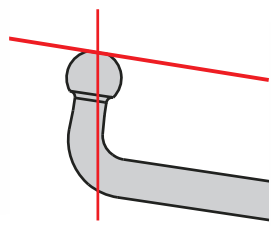
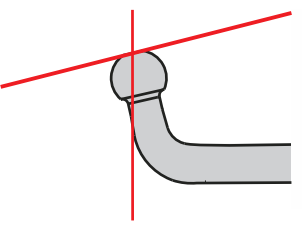
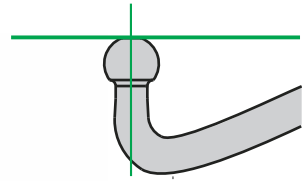
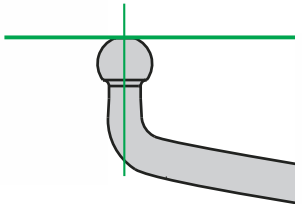
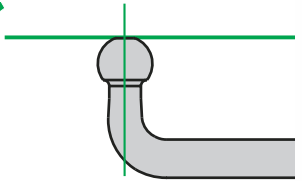
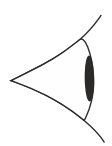

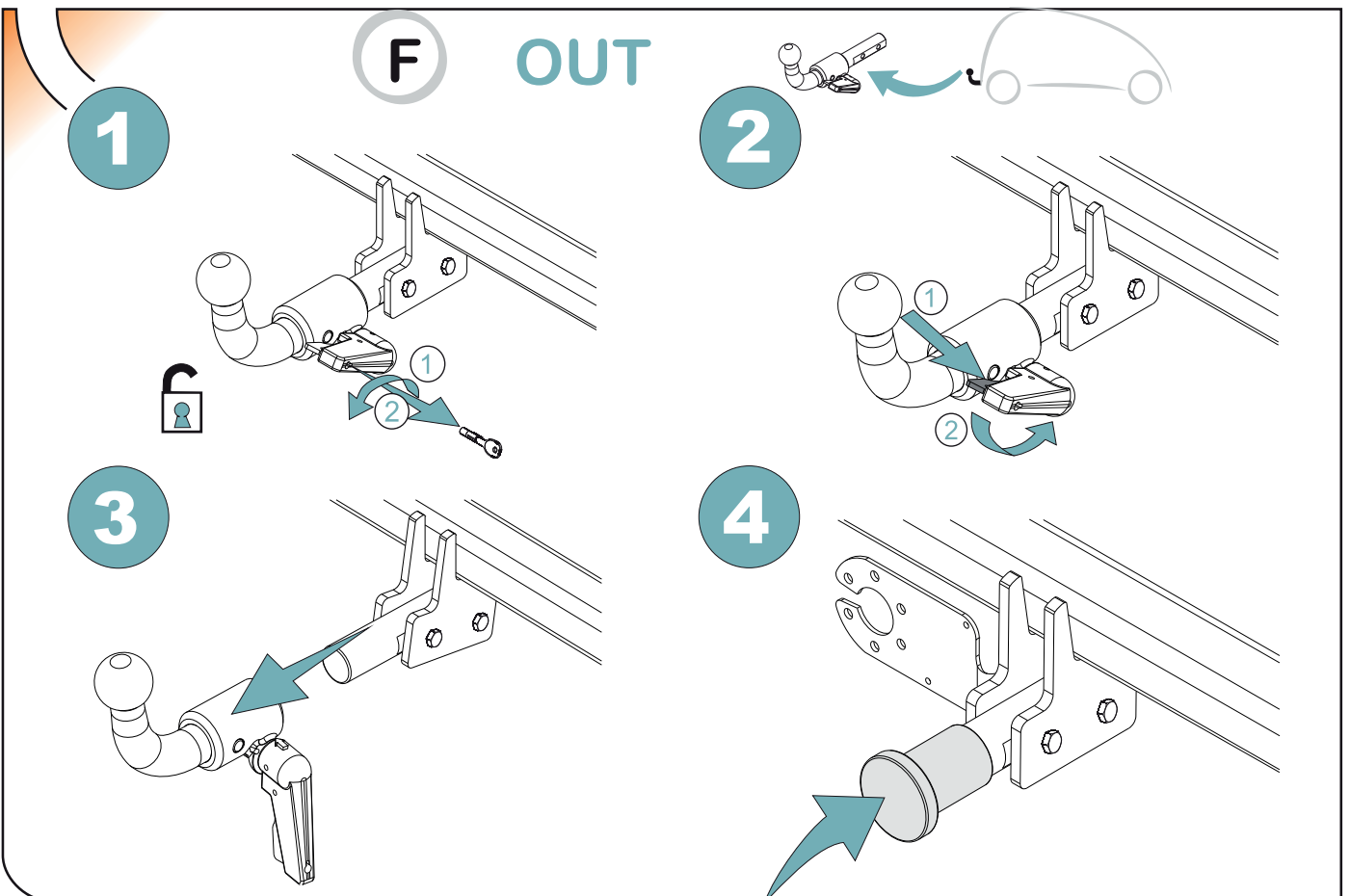
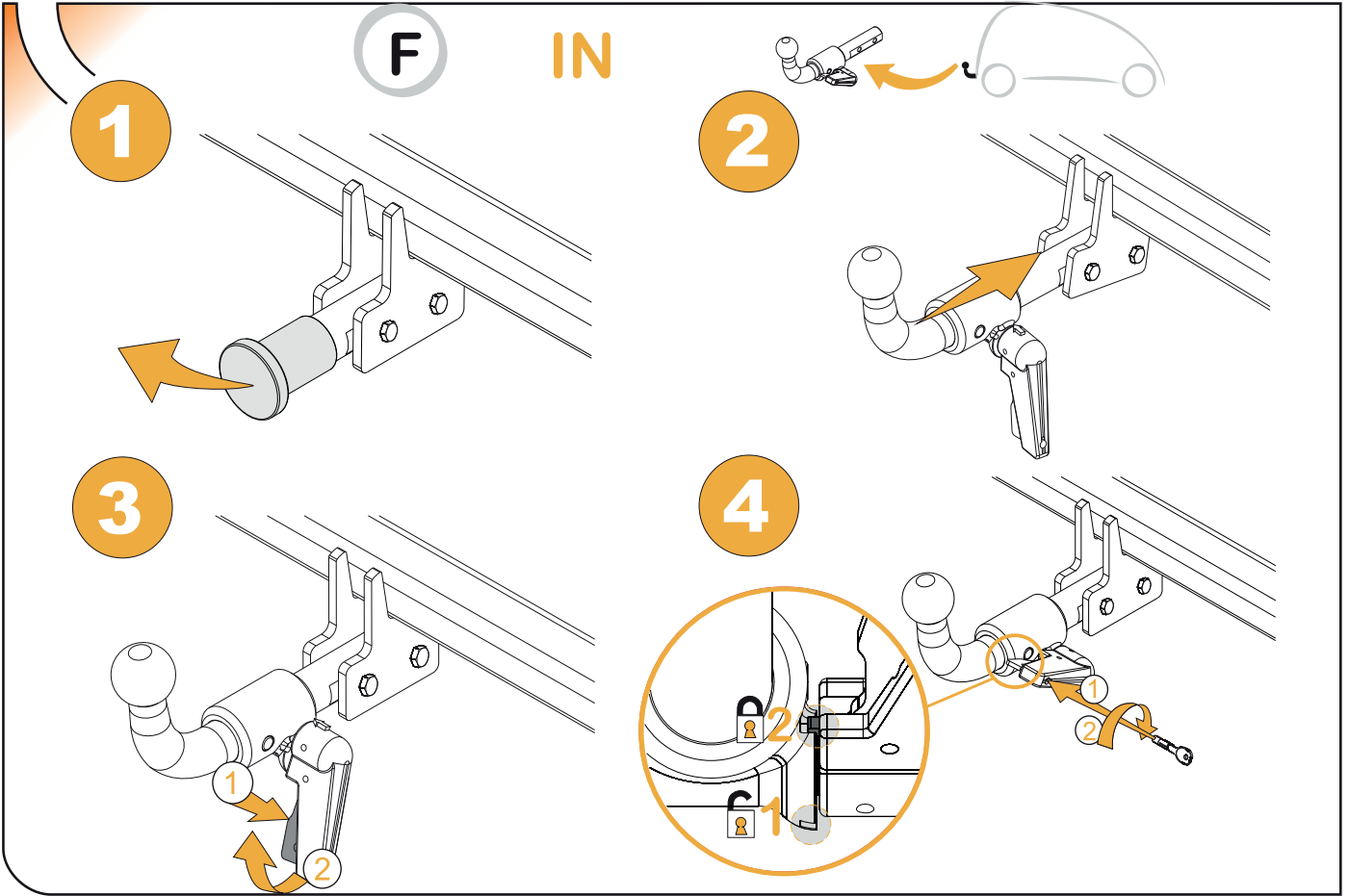

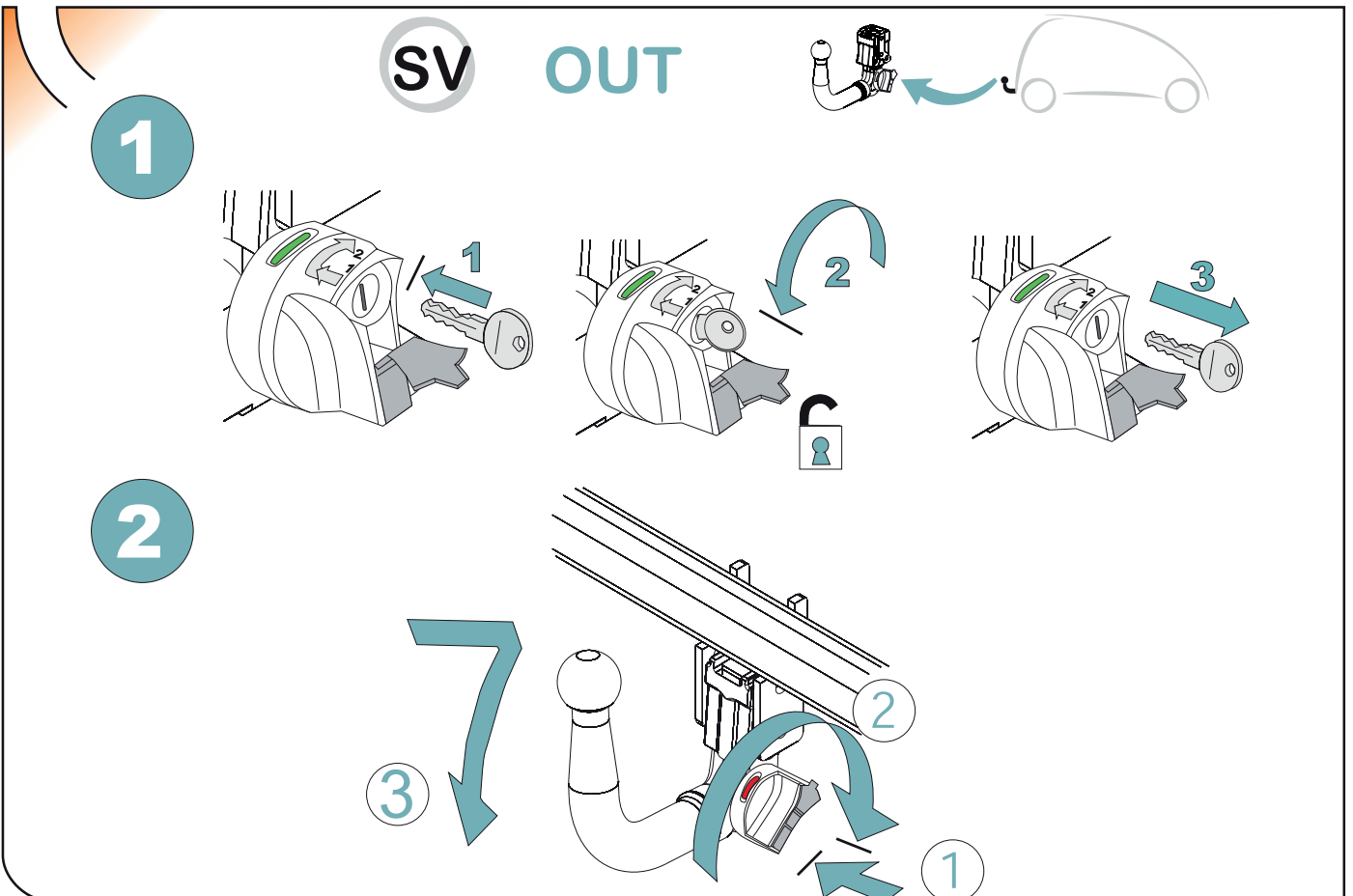
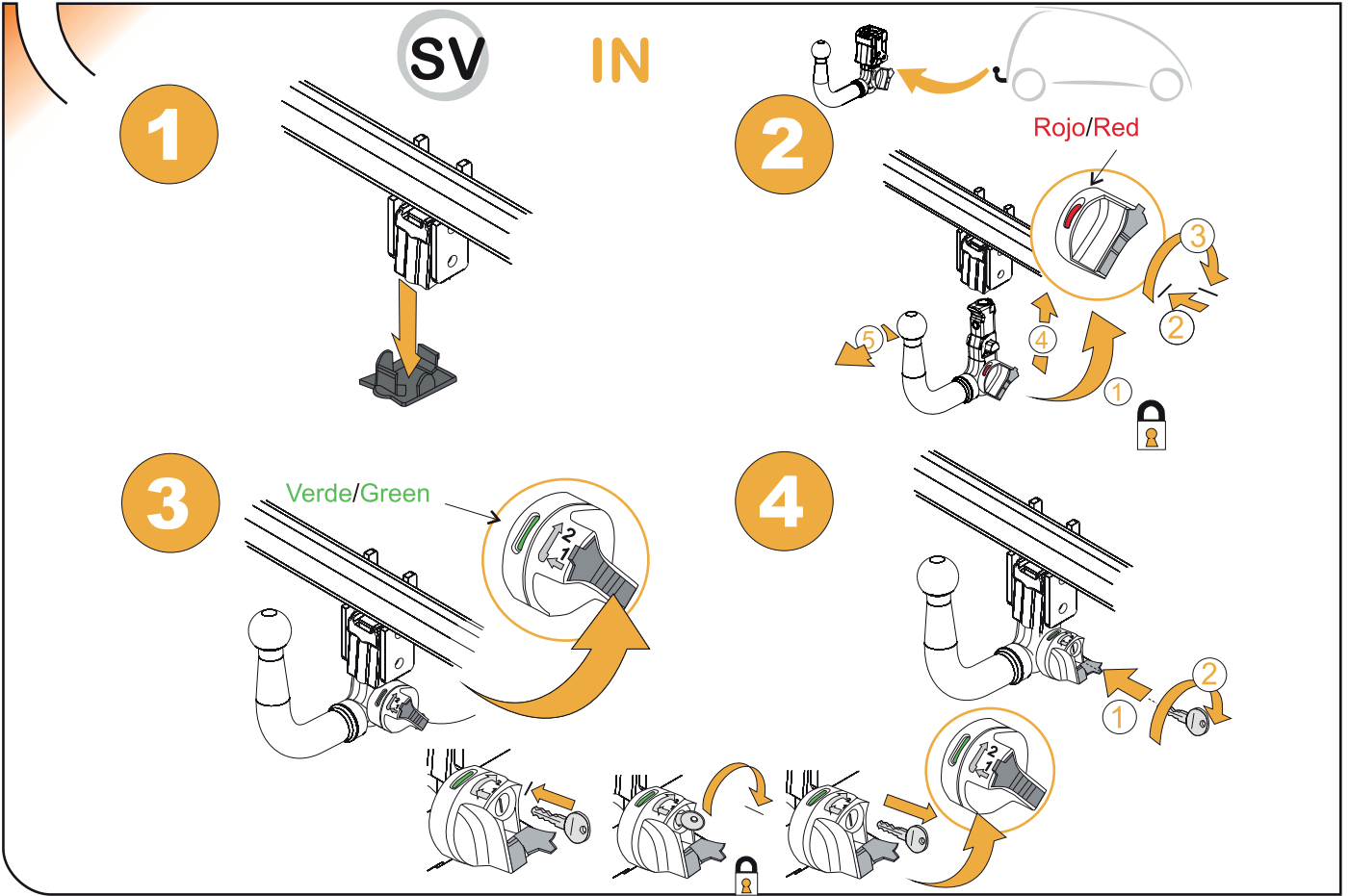

ANEXO III

CERTIFICADO DE TALLER

D. _____, expresamente autorizado por la _____
domiciliada en _____, teléfono _____, dedicada
a la actividad de _____ n° de Registro Industrial _____ y n° de registro
especial _____.

CERTIFICA

Que la mencionada empresa ha realizado la/s Reforma/s y asume la responsabilidad de la ejecución,
sobre el vehículo marca....., tipo.....
variante..... denominación comercial
matrícula y n° de bastidor, de acuerdo con:

- La normativa vigente en materia de reformas de vehículos.
- Las normas del fabricante del vehículo aplicables a la/s reforma/s llevadas a cabo en dicho vehículo.
- El proyecto descriptivo de la/s reforma/s, adjunto al expediente.

OBSERVACIONES: (2)

Tipificada/s con el código de reforma/s.....
Reforma consiste en:

COLOCACION DE ENGANCHE _____

n° de identificación / marca de homologación

Type :

Fecha:

Firma y sello:

Fdo:

(1) En el caso de que la reforma sea efectuada por el fabricante se indicará N/A.

(2) Se debe especificar en este apartado OBSERVACIONES, la identificación de los equipos o sistemas modificados, garantizando que se cumple lo previsto en el artículo 6 del reglamento general de vehículos y, en su caso, en el artículo 5 del R. D. 1457/1986 de 10 de enero, por el que se regula la actividad industrial en talleres de vehículos automóviles, de equipos y sus componentes, modificado por 455/2010 de 16 de abril, por el que se modifica el R. D. 1457/1986 de 10 de enero por el que se regulan la actividad industrial y la prestación.

ES

1

ANEXO III
CERTIFICADO DE TALLER



2



3



IT

1

DICHIARAZIONE DI CORRETTO MONTAGGIO

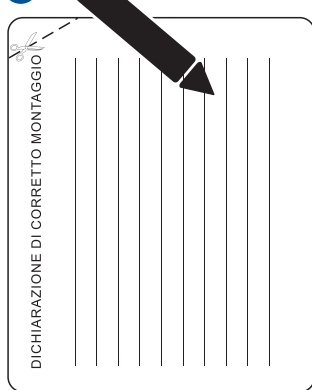

2

